

Traffic Control Plan:

www.invarion.com

Manifest	
16 x	Bollard
31 x	Cone
2 x	crane truck
7 x	ImBUS
1 x	ImLEFTARROW
8 x	ImONLY
7 x	ImRIGHTARROW
1 x	Mobile Crane
16 x	Pedestrian Tape
1 x	residents only
15 x	sign single
4 x	T1-19 prepare to stop
4 x	T1-200-3* traffic controller ahead symbolic night
3 x	T1-25 road work on side road
4 x	T1-6 detour ahead
3 x	T2-4 road closed
1 x	T5-1* detour (S)
1 x	T8-2L pedestrians (L)
1 x	T8-2R pedestrians (R)
2 x	T8-3 use other footpath
1 x	TC1819 SIDE ROAD CLOSED
5 x	Traffic Control

Legend

- Bollard
- Cone
- Job Site
- Mobile Crane
- Pedestrian Tape
- Traffic Controller
- Work Area

All advanced warning signs to be spaced as per RMS Roadwork on Worksite Handbook
 1 x Distance = Speed.

Date: 25/01/2018 **Author:** Dwayne Perera **Project:** 28 Broadway, Chippendale
Client: Forte Signs **Contact:** Nick Boswell **Phone:** 0409 188 210

Comments:
 This plan was designed by Dwayne Perera of Jims Traffic Control-Hornsby in accordance with Australian Standards and the RMS's Traffic Control on Worksite Handbook Version 4.0. The plan is designed for the safe closure of Chippendale Way, Chippendale, between Broadway and Central Park Avenue for the setup of a mobile crane and associated trucks for the erection of building signage. Certified Traffic Controllers will be on site to implement and monitor this TCP. If you have any question please contact Dwayne Perera of Jims Traffic Control-Hornsby on 0400 350 182

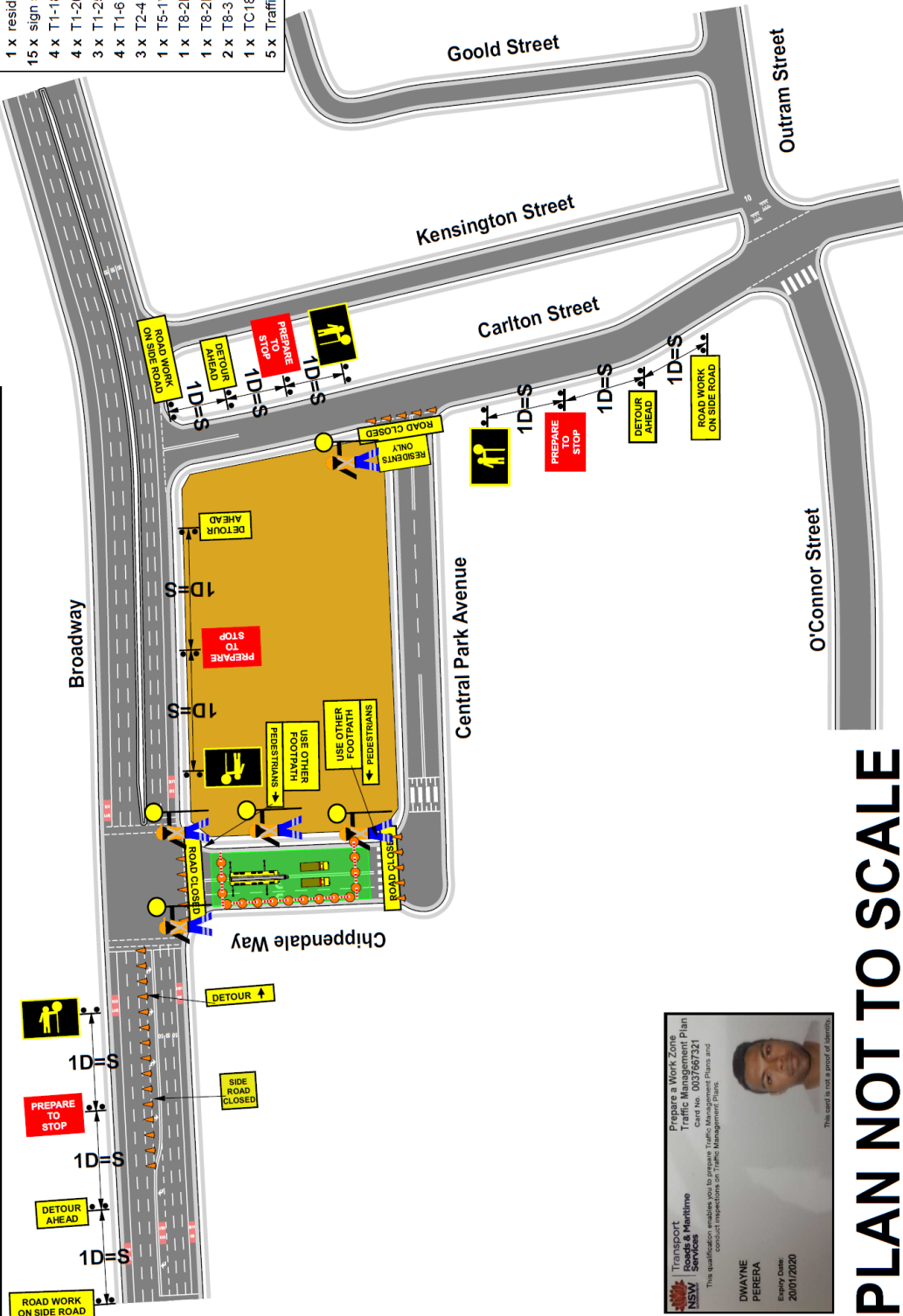

Jim's Traffic Control - Hornsby

Transport NSW Services
 This qualification enables you to prepare Traffic Management Plans and conduct inspections on Traffic Management Plans.

Prepare a Work Zone Traffic Management Plan
 Card No. 0037667321

DWAYNE PERERA
 Expiry Date: 20/01/2020

This card is valid in proof of identity.

PLAN NOT TO SCALE

